

2000 GPD WALL MOUNT RO WITH UTILITY SPECIFICATIONS

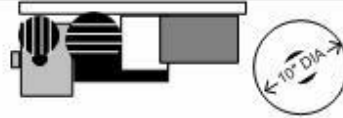

1/2" Conduit from Belanger equipment box sends 110v signal from Belanger power box to Pur Clean Reprressurization power box

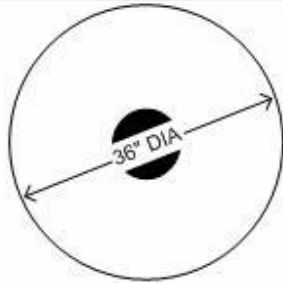
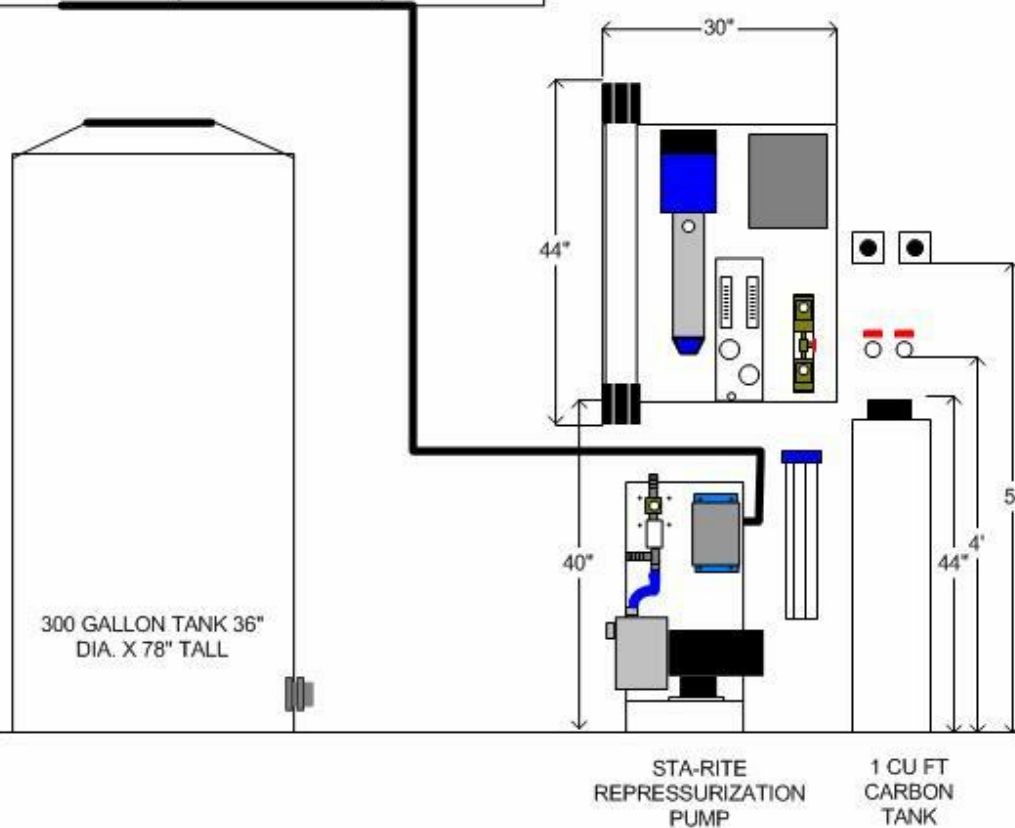

REQUIREMENTS

WATER

(2) 1" WATER LINES WITH FPT BALL VALVES, 20 GPM AT 30 PSI, ONE FOR REVERSE OSMOSIS SYSTEM. SECOND FOR AUTOMATIC BYPASS. MOUNT BOTH OF THESE 4 FEET FROM THE FLOOR TO THE RIGHT OF THE RO UNIT.

A DRAIN.

ELECTRICAL

(2) 220 VOLT 20 AMP SINGLE PHASE CIRCUITS EACH WITH ITS OWN L6-20 LOCKING RECEPTACLE. PUT THESE PLUGS 5 FEET UP FROM THE FLOOR TO THE RIGHT OF THE RO UNIT.

LOCATION: TO BE DETERMINED (HOUSTON TX)
DRAWN BY: CHARLIE BORCHARD
FILE NAME:2000WM
SCALE: 1/2" = 1'

